

## TECHNICAL SPECIFICATIONS

Item	031501
Voltage	DC 10-33V
Type	Switch Panel
Output	5 Groups
Load	Yes
Max Current	300mA(1 groups), 5mA(4 group)
Button	5 Buttons set by yourself
Mount	3M Adhesive

## 911 Signal Technology Inc.

Add:Room 701-702,Hengwei Building,No.258, Tiangao Lane,  
Shounan Subdistrict,Yinzhou Area,Ningbo City,  
Zhejiang,China.

Tel: +86 574 89017911 +86 400 6757911

Fax: +86 574 82822560

Email: sales@911signal.com

Website: www.911signal.com

# 911 SIGNAL®



## Master 5

## WIRING

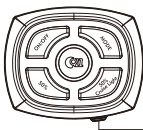

<b>RED</b> / 26AWG	TO +10-33VDC
<b>BLACK</b> / 26AWG	TO chassis ground
<b>YELLOW</b> / 26AWG / MAX 5mA	Mode
<b>BROWN</b> / 26AWG / MAX 300mA	ON/OFF
<b>ORANGE E</b> / 26AWG / MAX 5mA	50%
<b>PURPLE</b> / 26AWG / MAX 5mA	50% Cruise light
<b>WHITE</b> / 26AWG / MAX 5mA	None

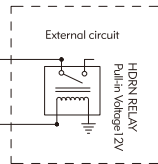

## MOUNT

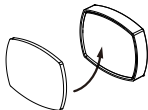

### STEP 1

Stick the 3M adhesive onto the back of the product

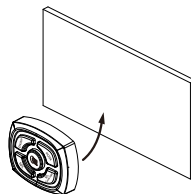

### STEP 2

Attach the product accordingly